



ABSRD-36-3 Bun & Roll Divider/Rounder 36-Part Semi-Automatic



MARKETING SPECIFICATION

Specified Bun and Roll Divider/Rounder shall be an ABSRD-36-3, 36-Part Semi-Automatic Bun Divider/Rounder with Solid Cast Iron Base finished in NSF Epoxy Paint, and fitted with Corner Interior Anchor System, Heavy-Duty Cast Aluminum Removable Head, Stainless Steel Dividing Knives, Hand-Operated Variable Rounding Control, Oil Bath Transmission, Heavy-Duty 3-Phase Motor with Silent Belt Drive, 3-Sanitary NSF Rounding Plates, Front and Rear Safety Covers and ETL/UL and ETL/NSF Listings meeting UL763 and NSF Standard 8.



Meets UL 763 and NSF-8 Standards



Model ABSRD-36-3 Bun & Roll Divider/Rounder 36-Part

STANDARD FEATURES

- Strong Cast Iron Base with Interior Anchor System
- Finished in NSF Epoxy Paint- Easy Clean & Chip Resistant
- Variable Rounding for Soft or Heavy Doughs
- Heavy Duty 3-Phase Motor with Silent Belt Drive
- Oil Bath Transmission Insures Long Life
- Sanitary NSF 36 Part Plastic Rounding Plates
- Safety Covers- Front and Rear

CONTROL AND PERFORMANCE FEATURES

- Heavy Cast Base for Rounding Stability
- Heavy Duty 220 Volt, 3 Phase, 60 Hz Motor
- Hand operated Lever for Degassing and Cutting
- Automatic Over-Current Protection with External Reset
- Variable Rounding allows for handling a variety of Dough Types
- Capacity: 6.75 lbs. dough Dough Pieces: .75 oz to 3 oz.
- 6 Foot Electrical Cord with NEMA Cord Cap

OPTIONS AND ACCESSORIES

- Single Phase Electric available

STANDARD PRODUCT WARRANTY

- One Year Parts and Labor on defective components (Contiguous USA and Canada Mainland)

ABSRD-36-3 – Bun & Roll Divider/Rounder 36 Part Semi-Automatic

AMERICAN BAKING SYSTEMS, INC.

290 LEGION COURT S.W. CEDAR RAPIDS, IA 52404 Phone:

319-373-5006 Fax: 319-373-5008

Email: INFO@ABS1.NET WEB: www.abs1.net



Bun & Roll Divider/Rounder ABSBRD-36-3

36-Part Semi-Automatic

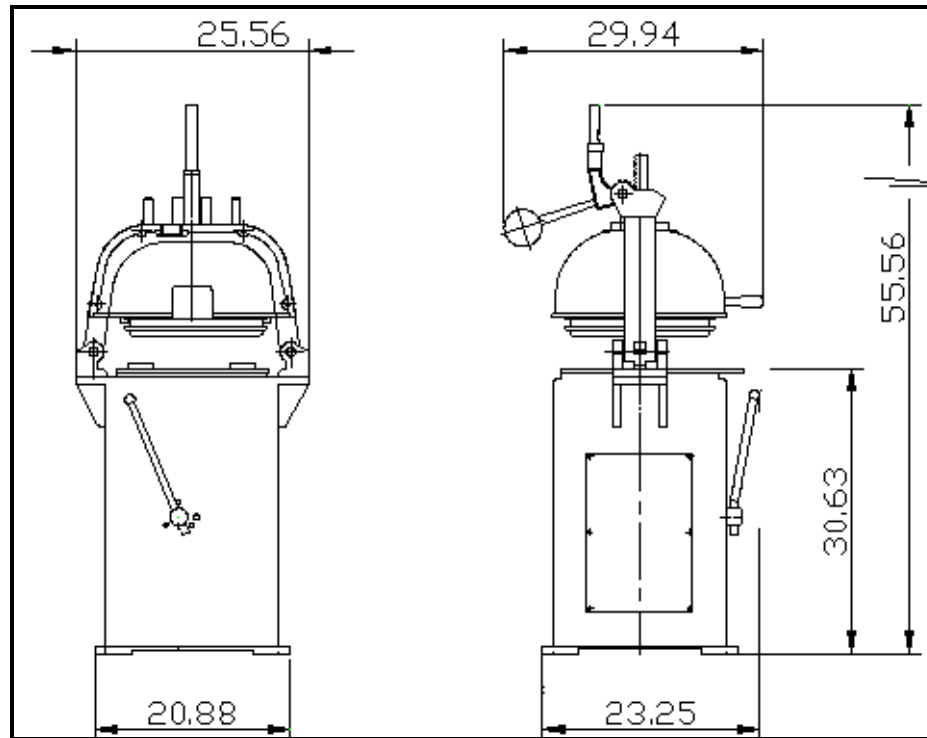

MODEL ABSBRD-36-3 UTILITY SPECIFICATIONS

| | |
|------------|--------------------------|
| Electrical | 208-220/60/3 |
| Plug | NEMA L15-20P |
| Breaker | 10 Amp Slow-Blow Breaker |
| Motor HP | 1.0 |
| Motor kW | 0.75 kW |

MODEL ABSBRD-36-3 CAPACITIES

| Model | Scaling Range |
|-------------|---------------|
| ABSBRD-36-3 | 7/8 - 3.0 oz |

SHIPPING

| Model | Crated Dimensions Height x Width x Depth | Unit Dimensions Height x Width x Depth | Weight | Net Weight | Freight Class | Door Clearance | Fork Lift Delivery Recommended |
|-------------|--|--|--------|------------|---------------|----------------|-----------------------------------|
| ABSBRD-36-3 | 62" x 29" x 33" | 52" x 26" x 30" | 790 | 650 | 85 | 36" or wider | Yes |