



## ABSDRD-36-4 Bun & Roll Divider/Rounder 36-Part Semi-Automatic



### MARKETING SPECIFICATIONS

Specified Bun and Roll Divider/Rounder shall be an ABSDRD-36-4, 36-Part Semi-Automatic Bun Divider/Rounder with Solid Cast Iron Base finished in NSF Epoxy Paint, and fitted with Corner Interior Anchor System, Heavy-Duty Cast Aluminum Removable Head, Stainless Steel Dividing Knives, Hand-Operated Variable Rounding Control, Oil Bath Transmission, Heavy-Duty 3-Phase Motor with Silent Belt Drive, 3-Sanitary NSF Rounding Plates, Front and Rear Safety Covers and ETL/UL and ETL/NSF Listings meeting UL763 and NSF Standard 8.



Meets UL 763 and NSF-8 Standards



### Model ABSDRD-36-4 Bun & Roll Divider/Rounder 36-Part

#### STANDARD FEATURES

- Strong Cast Iron Base with Interior Anchor System
- Finished in NSF Epoxy Paint- Easy Clean & Chip Resistant
- Easily Removable Head and Knife Assembly-Machine Washable
- Variable Rounding for Soft or Heavy Doughs
- Heavy Duty 3-Phase Motor with Silent Belt Drive
- Oil Bath Transmission Insures Long Life
- Sanitary NSF 36 Part Plastic Rounding Plates
- Safety Covers- Front and Rear 208/220/60/3

#### CONTROL AND PERFORMANCE FEATURES

- Heavy Cast Base for Rounding Stability
- Heavy Duty 220 Volt, 3 Phase, 60 Hz Motor
- Hand operated Lever for Degassing and cutting
- Automatic Over-Current Protection with External Reset
- Variable Rounding allows for handling a variety of Dough Types
- Capacity: 9 lbs. dough; Dough Pieces: 1 oz to 4 oz.
- 6 Foot Electrical Cord with NEMA L15-20P

#### OPTIONS AND ACCESSORIES

- Single Phase Electric available

#### STANDARD PRODUCT WARRANTY

- One Year Parts and Labor on defective components (Contiguous USA and Canada Mainland)

ABSDRD-36-4 – Bun & Roll Divider/Rounder 36 Part Semi-Automatic

AMERICAN BAKING SYSTEMS, INC.

290 LEGION COURT S.W. CEDAR RAPIDS, IA 52404 Phone:

319-373-5006 Fax: 319-373-5008

Email: INFO@ABS1.NET WEB: www.abs1.net



# Bun & Roll Divider/Rounder ABSBRD-36-4

## 36-Part Semi-Automatic

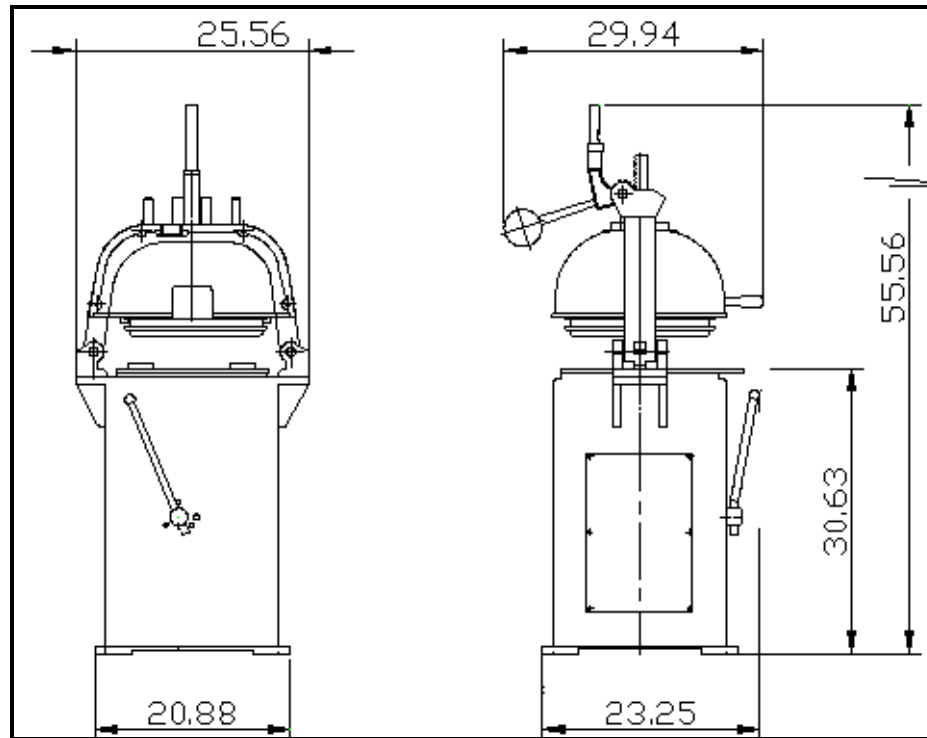

### MODEL ABSBRD-36-4 UTILITY SPECIFICATIONS

Electrical	208-220/60/3
Plug	NEMA L15-20P
Breaker	10 Amp Slow-Blow Breaker
Motor HP	1.0
Motor kW	0.75 kW

### MODEL ABSBRD-36-4 CAPACITIES

Model	Scaling Range
ABSBRD-36-4	1.25 - 4.0 oz

### SHIPPING

Model	Crated Dimensions Height x Width x Depth	Unit Dimensions Height x Width x Depth	Weight	Net Weight	Freight Class	Door Clearance	Fork Lift Delivery Recommended
ABSBRD-36-4	62" x 29" x 33"	52" x 26" x 30"	870	720	85	36" or wider	Yes