



ABSLBM-20 Long Bread Moulder



MARKETING SPECIFICATION

Specified Dough Moulder shall be an ABSLBM-20 with solid welded steel frame and Stainless Steel Body Panels, Three Roller Infeed system, infinite thickness settings for degassing rollers, Top and bottom infeed roller scrapers, Stainless Steel infeed with built in safety shut off, Emergency Stop Mounted at Eye Level, Heavy Duty Curling Belt, NSF approved Synthetic Felt Moulding Belts with Infinite Moulding Pressure adjusting system, High Torque Belt Drive system eliminates Gearbox, Heavy Duty Stainless Steel Stand with four locking casters and ETL/UL and ETL/NSF Listings meeting UL 763 and NSF Standard 7

Model ABSLBM-20 Long Bread Moulder

STANDARD FEATURES

- Strong Welded Steel Frame
- Stainless Steel Body Panels
- Heavy Duty High Torque Belt Drive
- Three Roller Infeed System with Safety Shut off
- Fully wrapped Easy Clean Curling Belt
- Infinite Thickness settings for Degassing and Moulding
- NSF approved Synthetic Felt Curling and Moulding Belts
- Heavy Duty Stainless Steel Stand
- Four Locking Casters for Operating Stability

CONTROL AND PERFORMANCE FEATURES

- Three Roller infeed System guides dough through Degassing Rollers
- High torque Belt Drive System Eliminates Gear Box
- Safety infeed guard and Emergency Stop Safety Features
- Automatic Over-Current Protection with Automatic Reset
- Emergency Stop
- Capacity: 800 Pieces per Hour
- 6 Foot Electrical Cord with NEMA Cord Cap

OPTIONS AND ACCESSORIES

- Single Phase Electric available

STANDARD PRODUCT WARRANTY

- One-Year Parts and Labor on defective parts (Contiguous US and Canada Mainland)



Meets UL 763 and NSF-8 Standards



AMERICAN BAKING SYSTEMS, INC.
290 LEGION COURT S.W. CEDAR RAPIDS, IA 52404 Phone:
319-373-5006 Fax: 319-373-5008
Email: INFO@ABS1.NET WEB: www.abs1.net



Long Bread Moulder

ABSLBM-20

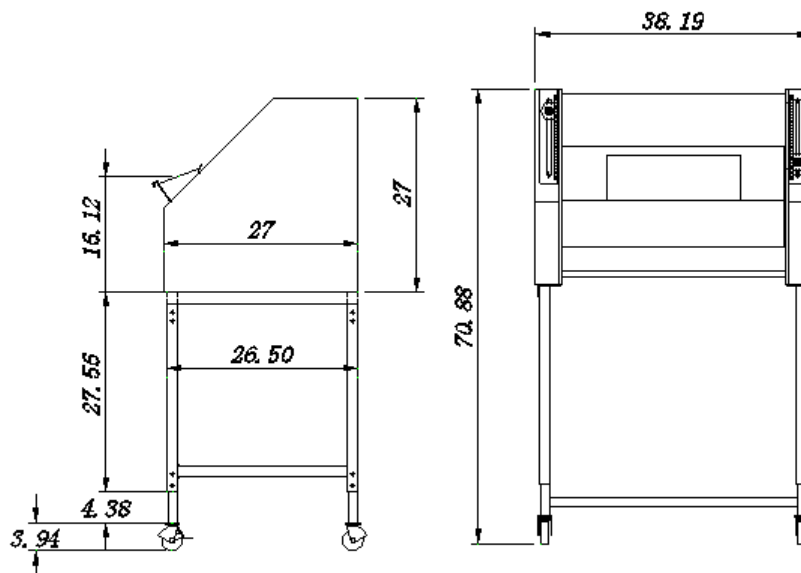

MODEL ABSLBM-20 UTILITY SPECIFICATIONS

| | |
|------------|--------------------------|
| Electrical | 220/60/3 |
| Plug | NEMA L15-20P |
| Breaker | 10 Amp Slow-Blow Breaker |
| Motor HP | 1.0 |
| Motor kW | 0.75 kW |

SHIPPING

| Model | Crated Dimensions Height x Width x Depth | Unit Dimensions Height x Width x Depth | Weight | Net Weight | Freight Class | Door Clearance | Fork Lift Delivery Recommended |
|-----------|--|--|--------|------------|---------------|--|-----------------------------------|
| ABSLBM-20 | 37" x 44" x 36" | 70.88" x 38.19" x 26.50" | 650 | 560 | 85 | Verify path from loading dock to install location. | Yes |